



520 West Ave – Restaurant, Medical, Retail or Office in densely populated Waypointe area
Norwalk, CT 06850
Fairfield County



Very Wide Double Storefront

About the space:

Building Size:	28,199 SF
Zoning:	CBDB
Built:	1930 – Historic Art Deco Building
Space Available:	1800 SF
Frontage:	30 FT
Uses:	Retail, medical, restaurant, café, office
Parking:	Ample parking available at the Berkley Apartments Garage
Asking Rent:	\$29/ SF NNN
Triple Net Charges:	Estimated at \$12.65/SF
HVAC:	Electric heat pumps
Seating:	Indoor and outdoor seating available
Ceiling Height:	11' to 13' clear
Traffic Count:	12,100
Building Features:	Art deco lobby / Dedicated en suite bath / ADA Accessible Restroom

All information is subject to errors and omissions

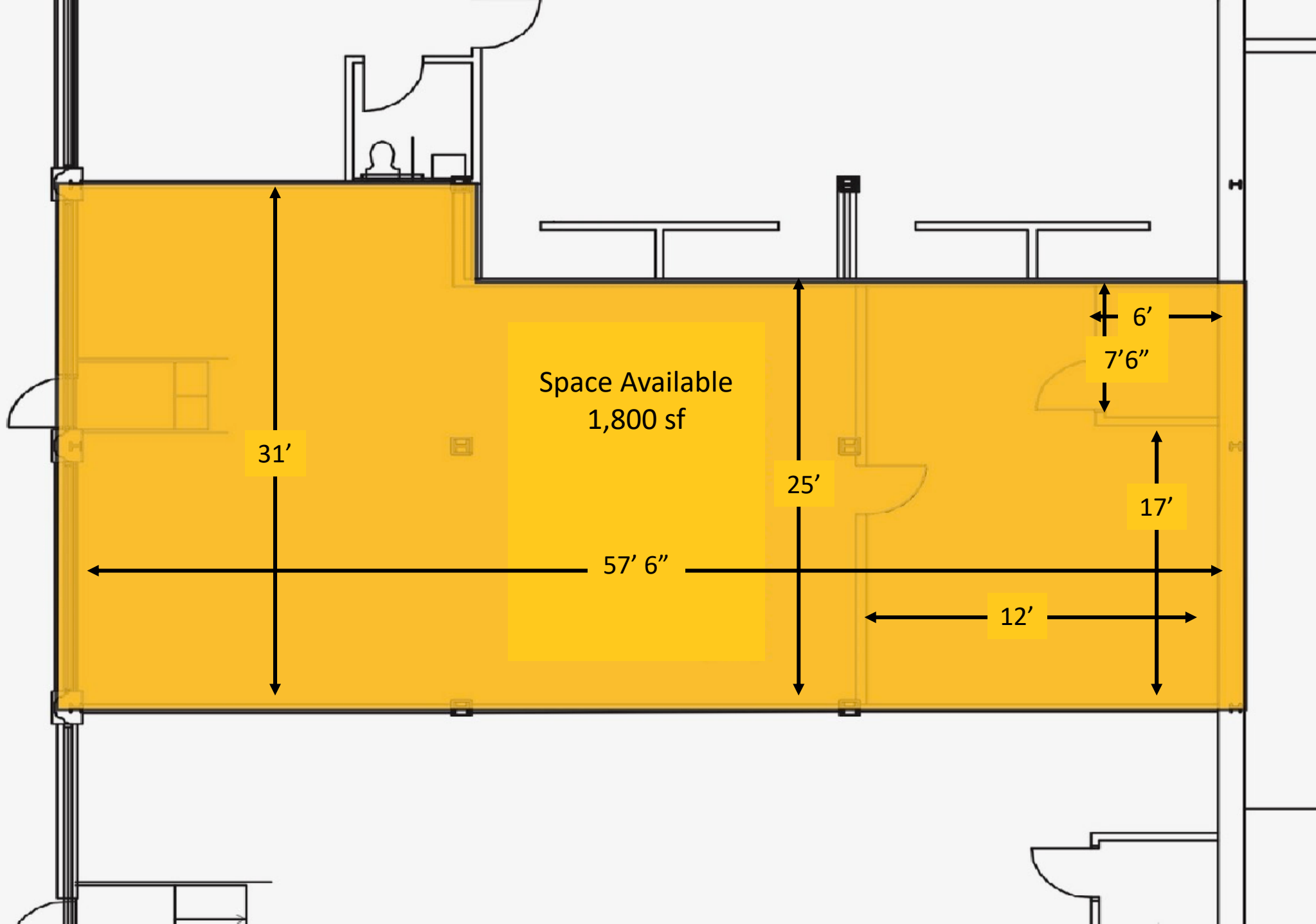

All information is subject to errors and omissions



	520 WEST AVENUE NORWALK, CT 06851	FIRST FLOOR PLAN	<small> DEVELOPED BY PROSPERITY 520 WEST AVENUE NORWALK, CT 06851 </small>
--	--------------------------------------	------------------	--

All information is subject to errors and omissions



All information is subject to errors and omissions



All information is subject to errors and omissions

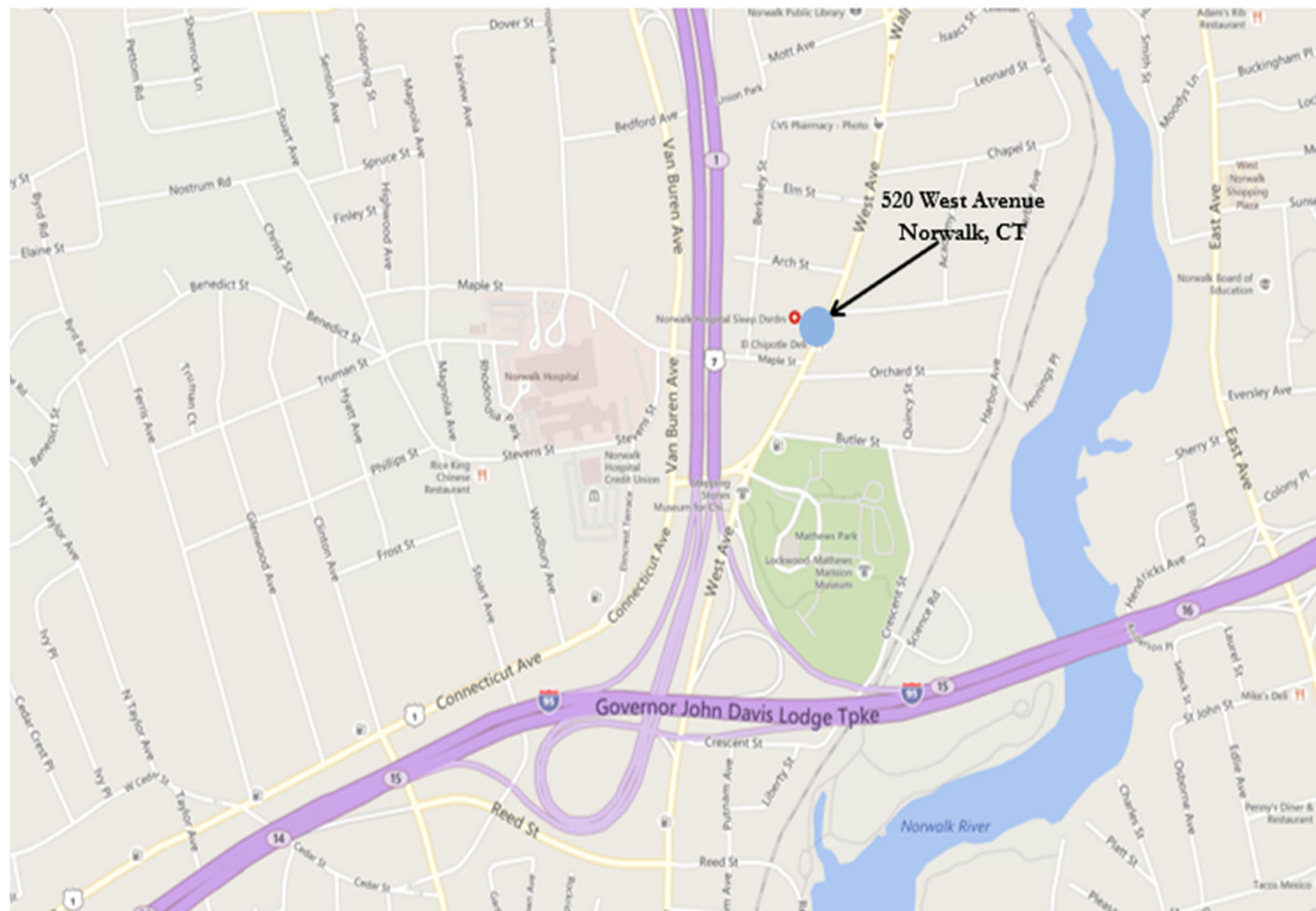

All information is subject to errors and omissions



For more information please contact:

Franco Fellah
Executive Vice President

HK Group
Commercial Real Estate
253 Riverside Avenue Westport, CT 06880
O: 203.454.8700
C: 203.981.3476
E: Ffellah@hkgrp.com

www.HKGRP.com

HK